

CITY OF WABASSO

Land Use Permit Info

City Council Approves all Permits at Regular Meetings

1. A land use permit is needed for new structures, additions, fences, patios, decks, sheds, permanent pools, any cement work, etc. if it changes existing dimensions or is newly added to a lot. Remodeling, maintenance or replacement in exactly the same size and shape does not.

2. All Structures need to be 10 feet from each side lot line and the back lot line; 30 feet from the front lot line or in line with other structures on that block

Note Lot line and street /curb or alley are NOT the same thing- Measuring from a street or alley must be done based on the Right of Way for that street or alley. Alleys are generally 20ft right of way. To estimate where your rear lot line starts, measure 10 feet from the center of the alley. Streets are not all the same width for the right of way. To begin an estimate of where your lot line is again take half of the right of way and measure from approximately the center line to find your lot line. The city should be able to give you information on the width of the right of way

Note To be sure your measurements are correct, having a survey done is recommended if the pins marking the corners of the lot are not easily found

3. If you will be closer to the side lot line than ten feet, your neighbor must sign a statement this is acceptable

4. For lots located on a corner, the city council will determine which is the front footage of the lot

5. On all Permits show distance from lot lines to structure, type of structure, estimated cost, address, name and in the case of a fence or shed or other structure that will be closer than ten feet to a shared lot line, a signed statement from the neighboring property owner stating that it is acceptable.

Example: Name John Jones
Address 999 Main Street
Structure being placed on property Patio & Shed
Estimated Cost \$3,200

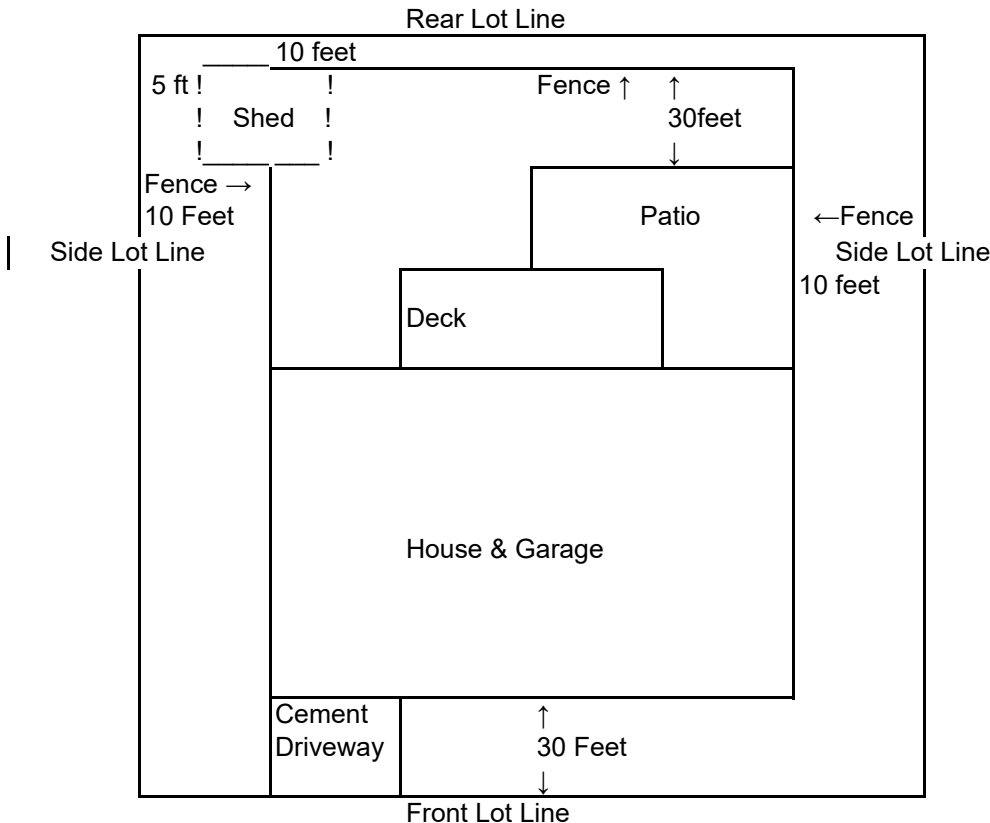

Placing the shed 5 feet from the property line is okay with me

Joe Blow 6/14/12

THIS FORM MUST BE ACCOMPANIED BY OVERHEAD PICTURE OF PROPERTY WITH PROJECT DRAWN ON IT. THIS IS TO SHOW LOCATION OF PROJECT RELATIVE TO PROPERTY LINES.

The overhead picture may be obtained through City Office or Beacon on the Redwood County website or other similar site.

Name: _____

Address: _____

Phone Number: _____ Alternate Phone: _____

E-Mail _____

Signature of Property Owner _____

Project Permit Needed For _____

Estimated Cost of Project: _____

Signature of adjoining property owners if project will be closer than 10 feet from side or back property line
